



Freehold Ground Rent Investment For Sale - Palmers Green London N13

2 x two bedroom flats with c 59.5 years remaining

GILMARTIN LEY

**67 Palmerston Crescent,
Palmers Green,
LONDON, N13 4UD**



Area

Net Internal Area: 132 sq.m. (1,420 sq.ft.)

Price

Offers in excess of £65,000 subject to contract



Property Description

The property comprises two flats which have been converted from a semi-detached Edwardian house. There is one ground floor garden flat and one first floor flat.

Both flats have leases of 99 years from July/September 1976. There are therefore circa 59.5 years remaining on each lease.

The annual ground rent for each flat is as described in the schedule below.

Please note that the stated areas are approximate only.

Comparable evidence includes:

Ground floor garden flat, 50a Palmerston Crescent, 701 sq ft plus cellar which sold for £355,000 in October 2015, and

First floor flat, 32 Elmdale Road, c. 700 sq ft and with its own share of the rear garden which sold for £345,000 in September 2015

Accommodation	Area sq.m.	Area sq.ft.	Comments
Ground Floor Garden Flat	66	710	99 years from 24th September 1976. Ground rent passing £50 per annum increasing to £75 in 2042 for the remainder of the term.



GILMARTIN LEY

Freehold Ground Rent Investment For Sale - Palmers Green London N13

2 x two bedroom flats with c 59.5 years remaining

Accommodation	Area sq.m.	Area sq.ft.	Comments
First Floor Flat	66	710	99 years from 12th July 1976. Ground rent passing £50 per annum increasing to £75 in 2042 for the remainder of the term.

Property Location

The subject property is located in Palmers Green a popular and improving North London suburb. The property is situated on the south east side of Palmerston Crescent which runs west from Green Lanes (A105).

Palmers Green Railway Station (Zone 4) is located 500 metres to the north providing frequent services to London Moorgate.

Green Lanes provides numerous retail and leisure facilities including Starbucks, McDonalds, Barclays Bank, HSBC, Holland & Barrett, Costa Coffee, Boots and Waitrose.

Service Charge p.a. The leaseholders are responsible for repairing and insuring the property. The ground floor flat includes the foundations and the first floor flat includes the roof.

Terms Freehold for sale subject to the two leases as described in the schedule. Please note that notices will need to be served on the leaseholders prior to the property being sold to comply with the legislation.

Legal Fees: Each party is to bear its own legal fees

Local Authority: London Borough of Enfield

Viewings: Viewings are to be carried out from the roadside only.

Further information at: <http://www.gilmartinley.co.uk/properties/24272>
Ground floor lease
First floor lease
Freehold title

Last Updated: 01 Jul 2016

Gilmartin Ley for themselves and for the vendor / lessor of the property whose agent they are give notice that:

(1) these details are set out as a general outline only for the guidance of intended purchasers or lessees and do not constitute, not constitute part of, an offer or contract; (2) all descriptions, dimensions, reference to condition and necessary permissions for use and occupation, and other details are given without responsibility; any intending purchasers or lessees should not rely on them as statements or representations of fact but must satisfy themselves by inspection or otherwise as to the correctness of each of them; (3) no director or person in the employment of Gilmartin Ley has any authority to make or give any representation or warranty whatever in relation to any of the properties on this website; (4) we have not tested any of the services, such as heating, power supplies, lighting, fire or security alarms etc. serving any of the properties on this website and therefore are unable to confirm that they are in satisfactory working condition or comply with appropriate regulations; (5) all rentals and prices quoted are exclusive of VAT, unless otherwise stated.



GILMARTIN LEY

Freehold Ground Rent Investment For Sale - Palmers Green London N13

2 x two bedroom flats with c 59.5 years remaining

67 Palmerston Crescent, London N13 4UD

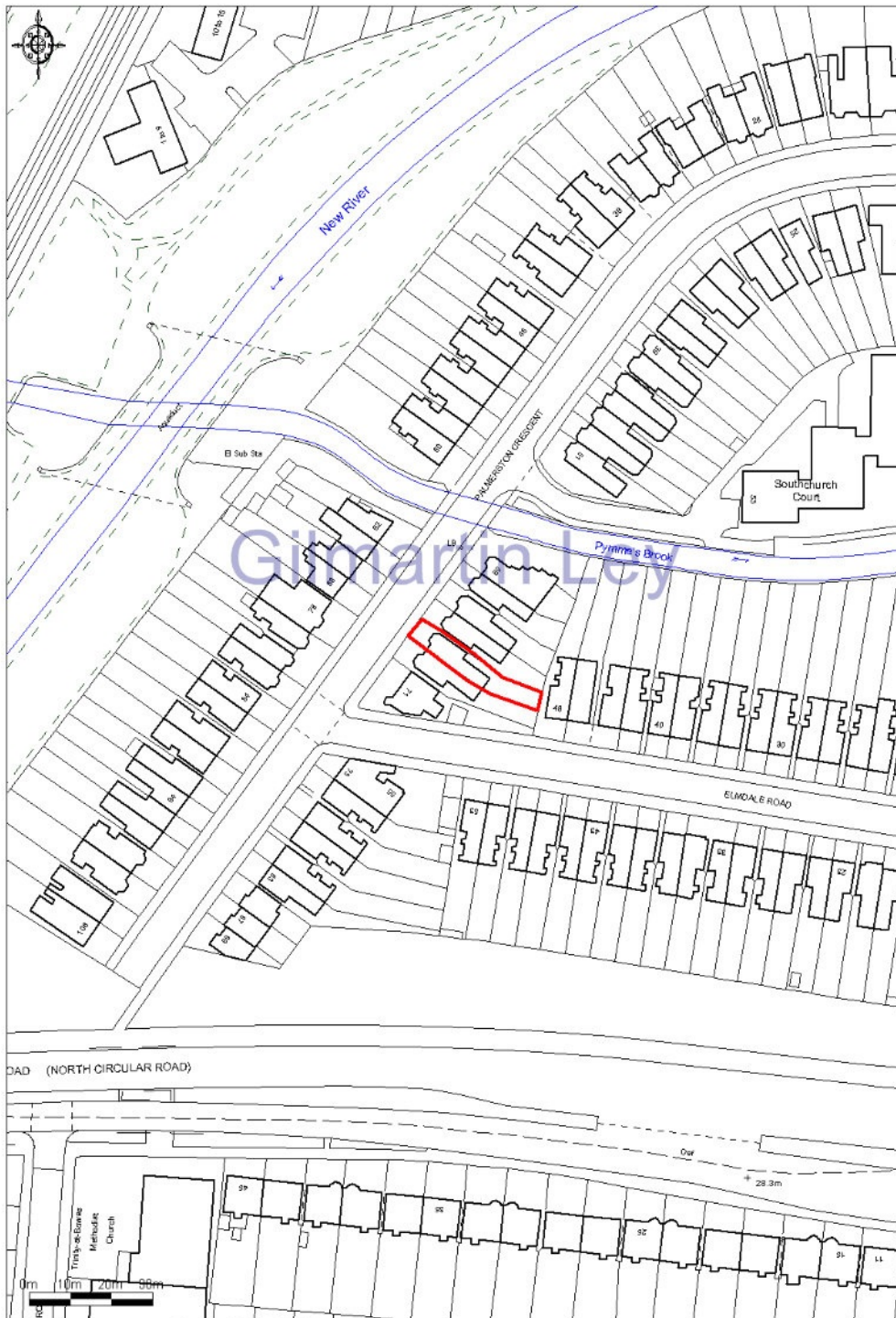

Promap Map © Crown Copyright 2010. All rights reserved. Licence number 100019121. Printed on 11/10/10

Gilmartin Ley - for indicative purposes only

<http://www.gilmartinley.co.uk/properties/for-sale/ground-rent-investments/palmers-green/london/n13/24272>

Our ref:

4272

Property Investment and Development Consultants
Commercial Estate Agents and Valuers
Chartered Surveyors and Estate Managers
Property Experts for North London

Gilmartin Ley
Alfred Imber House, 62a Highgate High Street
Highgate, London N6 5HX
www.gilmartinley.co.uk

Tel: +44 (0)20 8882 0111
Fax: +44 (0)20 3137 9053
Email: agencyl@gilmartinley.co.uk
Twitter: @gilmartinley



GILMARTIN LEY

Freehold Ground Rent Investment For Sale - Palmers Green London N13

2 x two bedroom flats with c 59.5 years remaining

67 Palmerston Crescent Palmers Green London N13 4UD



Gilmartin Ley

<http://www.gilmartinley.co.uk/properties/for-sale/ground-rent-investments/palmers-green/london/n13/24272>

Our ref:

Property Investment and Development Consultants
Commercial Estate Agents and Valuers
Chartered Surveyors and Estate Managers
Property Experts for North London

Gilmartin Ley
Alfred Imber House, 62a Highgate High Street
Highgate, London N6 5HX
www.gilmartinley.co.uk

Tel: +44 (0)20 8882 0111
Fax: +44 (0)20 3137 9053
Email: agencyl@gilmartinley.co.uk
Twitter: @gilmartinley